

Planetary Small Geared Motor PE with DC Motor, Size 2

Housing: Steel, zinc-plated, sealed against lubricant leaks and protected against dust, can be mounted in any position.

Gearbox: 1st gearbox stage: plastic gears, other gears made from steel.

Bearing: Motor roller bearing. Gearbox roller bearing / plain bearing.

Lubrication: Maintenance free grease lubrication.

Motor: Brushed DC motor 24 V.

Nominal motor speed 3,000 min⁻¹. Pinion milled into motor shaft.

Free lead ends. Sense of rotation can be changed by swapping

leads over. Protection class: IP 41.

Insulation class: F.

Operating mode: S1.



Ordering Details: e.g.: Type, Size 2, Voltage, Output Speed, Product No.

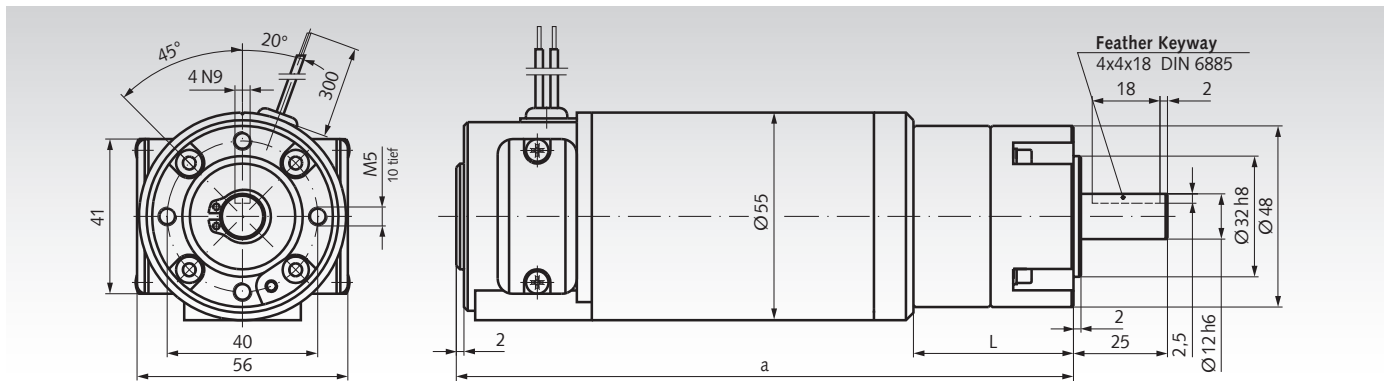

Size 2

Product No. 24 V	Nominal Output Speed min ⁻¹	Ratio i	max. continous Torque Nm	max. Starting Torque Nm	Nominal Motor Power W	Output Power W	Gearbox Efficiency %	a mm	b mm	Weight kg
430 450 24	600	5:1	1,00	3,0	54	49	90	164,5	43,0	1,5
430 451 24	500	6:1	1,30	3,5	54	49	90	164,5	43,0	1,5
430 452 24	392	7,66:1	1,00	3,0	46	41	90	164,5	43,0	1,5
430 453 24	143	21:1	3,20	12,0	55	47	85	181,0	59,5	1,6
430 454 24	120	25:1	4,00	14,5	55	47	85	181,0	59,5	1,6
430 455 24	100	30:1	4,80	14,5	55	47	85	181,0	59,5	1,6
430 456 24	83	36:1	5,50	16,0	55	47	85	181,0	59,5	1,6
430 457 24	65	46:1	5,60	16,0	45	38	85	181,0	59,5	1,6
430 458 24	51	59:1	6,00	16,0	48	32	85	181,0	59,5	1,6

Permissible radial shaft load F_R : from $i=5:1$ to $i=7,66:1$: 112 N; from $i=21:1$ to $i=59:1$: 150 N (always middle shaft).

Permissible axial shaft load F_A : from $i=5:1$ to $i=7,66:1$: 100 N; from $i=21:1$ to $i=59:1$: 110 N.

Tolerances +/- 10%.

Note

The efficiency stated in the table is valid for properly run-in gearboxes at operating temperature. To prevent the gearbox from being overloaded, the stated limit loads must not be exceeded. At reversed operation the limit loads must be multiplied with the factor 0.75.

Optionally also available with DC speed sensor, incremental encoder and brake.

Also available as an option with larger gear ratio up to 450:1.

Speed controllers

Page 916

